

DHI-LPH65-MC470-P

65 inch Smart Interactive Whiteboard

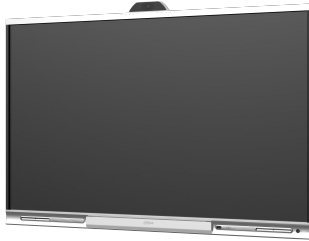

Series Overview

Dahua DeepHub Pro Smart Interactive Whiteboard is a new generation of smart interactive whiteboards that have a high performance main controller and multiple intelligent functions. It adopts direct-type LED backlight technology and has a 4K LED display that is built of anti-dazzle tempered glass with a hardness of 7 on the Mohs scale. The display comes in 65", 75", 86" and 98". This ultra-thin whiteboard supports up to 20 multi-user writing points and is equipped with a 48 MP motorized lens, speakers, 8 microphone arrays, and is touchscreen. It offers various functions such as video conferencing, writing on the whiteboard, wireless screen sharing and allows you to scan codes to access content on the whiteboard.

Functions

4K HD Display

With up to 3840 × 2160 resolution, the 4K HD display delivers a clear image in sharp, vivid colors.

AI Recognition of Drawings

Identifies hand-drawn structures such as straight lines, arrow-straight lines, arrow-dotted lines, triangles, parallelograms, trapezoids, rectangles, pentagons, circles, cylinders, pentagrams, semicircles, and ellipse.

Easy to Share

Enhances the experience of sharing files by scanning a code. It automatically determines the network of the device to readily share the QR code across the extranet and the intranet. QR code encryption and extraction are also featured, providing privacy and data security through the required entry of a 6-digit password for verification.

File Management

Supports managing and using Office files, image, video and audio files, and file formats such as PDF and TXT.

Similar to Real Writing Experience

The electronic whiteboard supports pen-point writing. It comes equipped with specialized pressure-sensitive writing pens, designed to enhance the writing experience. With its soft, comfortable nib, writing on the whiteboard feels natural, similar to the real writing experience.

- Built-in DeepHub Meeting Software for cloud base online conference and with Realtime collaboration function.
- Displays in 4K Ultra HD and uses 4K UI.
- With its 2 built-in mid-high frequency speakers, and 1 low-frequency speaker, the device supports 2.1-channel audio output. The total power is 60 W.
- Produces vibrant visuals through its high color coverage (90% NTSC High Gamut Screen) and accurate color reproduction ($\Delta E \leq 1.5$).
- Features split screen, and performs screen sharing between the whiteboard and phones, computers, tablets and more devices.
- Microsoft Office and other related software can be installed, and it can play audio and video files in various formats.
- Offers a smooth writing experience through handwriting recognition, pen writing, the fast writing response speed, and pen pressure recognition for a real writing experience.
- Support AI recognition of text and drawings.
- Intelligent pen detection that automatically wakes up the whiteboard for annotations when the pen is lifted.
- Built-in AI 48M camera and 8 array microphone that produces excellent quality visual and audio communication. Supports auto-framing and voice tracking.
- Features sound source positioning.
- NFC and Fingerprint unlock for protection of user information.
- Includes a full-featured Type-C IN port and supports charging through USB PD up to 65 W.

Wireless Screen Sharing

In addition to basic file sharing, the device offers wireless screen sharing, interactive operations between two screens, and reverse transmissions. It also supports screen grouping (multiple transmission), host mode (for overall permission control), real-time transmission of images, videos and audios from the wireless camera of the mobile phone to the device, and split-screen mode that displays up to 9 splits on the same screen.

Screen Sharing

The content on your screen can be freely shared with one other device through a wired connection.

4K Camera with Ultra-wide FOV

8-MP with a maximum resolution of 4K@30 fps. It supports live videos and has an ultra-wide field of view (diagonal 99°, horizontal 87°, and vertical 49°), displaying vivid images even when placed in relatively large meeting rooms.

Technical Specification

Built-in System	
Operating System	Android 11.0
CPU	Quad-core A73 + Quad-core A53
CPU Frequency	2.2 GHz + 2.0 GHz
GPU	ARM Mali-G52 MP8 (8EE)
RAM	12 GB (System: 8 GB, Camera: 4 GB)
ROM	128 GB
Card Swiping with NFC	Yes, Bind up to 10 cards

Function	
Operating System of External Module	Windows 7/8/10
Wi-Fi Hotspot	Dual-band 2.4 G/5 G; supports enabling Hotspot and Wi-Fi at the same time

LCD Panel	
Panel Dimensions	65 inch
Backlight	DLED
Aspect Ratio	16:9
Brightness	350 cd/m ² (typ.)
Resolution	3840 (H) × 2160 (V)
Viewing Angle	H: 178°; V: 178°
Lifespan	≥50, 000 h
Display Color	90% NTSC (typ.)
Refresh Rate	60 Hz
Static Contrast	VA: 4000 (typ.); IPS: 1200 (typ.)
Response Time	8 ms (typ.)

Camera	
Pixel	48 MP
Auto Control	Auto flip; Auto white balance
Distortion	−8.6%
Max. Resolution	3840 (H) × 2160 (V)
Storage	8GB eMMC
Field of View	D: 99°; H: 87°; V: 49
Face Detection	Yes

Device Ports	
Light Sensor	1
Front Button	1 × power button (right side)
Front Ports	1 × USB 3.0 (left side)
Network Port	1 × RJ-45
Wi-Fi	Yes, 1 × Station, 1 × AP
Wi-Fi Standard	Station: 802.11b/g/n/a/ac AP: 802.11b/g/n/a/ac/ax

Wi-Fi Frequency Range	2400-2483.5 MHz, 5150-5350 MHz, 5470-5725 MHz, 5725-5850 MHz
MAX Power Transmission (Wi-Fi)	≤20 dBm@2400-2483.5 MHz; ≤23 dBm@5150-5250 MHz; ≤20 dBm@5250-5350 MHz; ≤27 dBm@5470-5725 MHz; ≤14 dBm@5725-5850 MHz
Bluetooth	Yes
Bluetooth Standard	BR/EDR/BLE, BT5.2
Bluetooth Frequency Range	2400-2483.5 MHz
MAX Power Transmission (Bluetooth)	≤20 dBm@2400-2483.5 MHz
RFID Modulation Method	ASK
RFID Frequency Range	13.56 MHz
MAX Power Transmission (RFID)	42 dBuA/m @10m
USB	3 × USB 3.0 (type A); 1 × Micro USB2.0
RS-232	1 × DB9 interface, male connector
Video Input	2 × HDMI 2.0 (4K@60Hz)
Video Output	1 × HDMI 2.0 (4K@60Hz)
Audio Output	1 × 3.5 mm Line Out interface; 1 × SPDIF interface
Others	1 × Touch interface
IrDA	1
Microphone	8 Array
Type-C Port	1× Type-C IN (DP IN (4K60fps) +USB3.0 HOST+USB 2.0 Device (touch) +PD 65 W)

Touchscreen	
Response Time	≤10 ms
Touch Technology	Infrared touch technology
Touch Points	31@Android, 50@windows
Valid Touch	1.5 mm (0.06") (over 90% touch area)
Writing Mode	Finger + Pen (attaches magnetically)
Anti-light Interference	Anti-dazzle tempered glass
Surface Hardness	≥9 H
Touch Resolution	32767 × 32767
Number of Multi-user Writing Points	10 (over 90% touch area)

Speaker	
Number of Cavities	3
Frequency	150 Hz–20 kHz
Power	2.1 Channel, front full-range 2 × 20 W + rear subwoofer 20 W
Built-in Speaker	3
Fingerprint	
Fingerprint Capacity	100
Fingerprint Resolution	160 × 160

FAR	<0.001%
Microphone	
Pick-up Distance	Far-field sound pickup: 8 m—12 m (26.25 ft—39.37 ft)
Number of Microphones	8 Array
AGC	Yes
Echo Cancellation	Yes
Polar Pattern	Omnidirectional
Intelligent Noise Filtering	YES

General	
Power Supply	100—240 VAC, 50/60 Hz
Power Consumption	Basic power consumption: 221 W, Max. Power consumption: 300 W
Operating Temperature	0 °C to +40 °C (+32 °F to +104 °F)
Storage Temperature	−20 °C to +60 °C (−4 °F to +140 °F)
Operating Humidity	10%—90% (RH), non-condensing
Storage Humidity	10%—90% (RH), non-condensing
Product Material	Metal casing
Protective Glass	3.2 mm Anti-dazzle tempered glass
Casing Color (Frame/Rear)	Black on the left and right, silver on the top and bottom.
Product Dimensions	1485 mm × 93.1 mm × 968.5 mm (58.46" × 3.67" × 38.13") (L × W × H)
Frame Size	Top border: 26.1 mm, left and right borders: 15.4 mm, bottom border: 66.6 mm
Packaging Dimensions	1590 mm × 262 mm × 1056 mm (62.60" × 10.31" × 41.57") (L × W × H)
Net Weight	43 kg (94.80 lb)
Gross Weight	52.7 kg (116.18 lb)
Holes Distance	500 mm × 400 mm (19.69" × 15.75")
Installation	Wall mount; mobile bracket
Standby Power Consumption	≤0.5 W
Packing List	1 × Smart interactive whiteboard; 1 × Power cord; 2 × Stylus pen; 1 × Quick start guide; 1 × Wall mount bracket; 1 × Accessory package; 1 × Remote control

Dimensions (mm[inch])

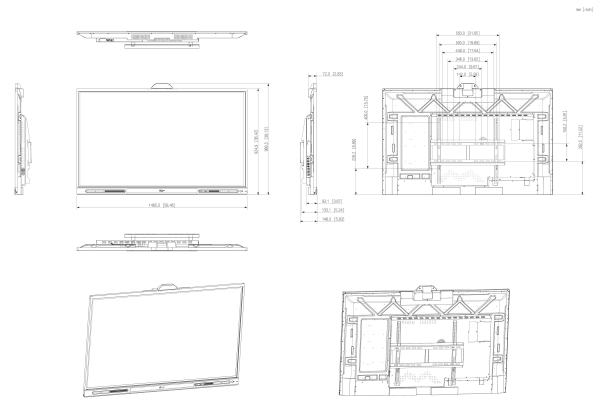

Panels

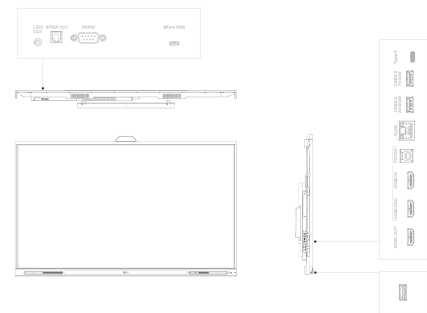

Ordering Information

Type	Model	Description
Smart interactive whiteboard	DHI-LPH65-MC470-P	65 inch Smart Interactive Whiteboard

DHI-LPH75-MC470-P

75 inch Smart Interactive Whiteboard



Series Overview

Dahua DeepHub Pro Smart Interactive Whiteboard is a new generation of smart interactive whiteboards that have a high performance main controller and multiple intelligent functions. It adopts direct-type LED backlight technology and has a 4K LED display that is built of anti-dazzle tempered glass with a hardness of 7 on the Mohs scale. The display comes in 65", 75", 86" and 98". This ultra-thin whiteboard supports up to 20 multi-user writing points and is equipped with a 48 MP motorized lens, speakers, 8 microphone arrays, and is touchscreen. It offers various functions such as video conferencing, writing on the whiteboard, wireless screen sharing and allows you to scan codes to access content on the whiteboard.

Functions

4K HD Display

With up to 3840 × 2160 resolution, the 4K HD display delivers a clear image in sharp, vivid colors.

AI Recognition of Drawings

Identifies hand-drawn structures such as straight lines, arrow-straight lines, arrow-dotted lines, triangles, parallelograms, trapezoids, rectangles, pentagons, circles, cylinders, pentagrams, semicircles, and ellipse.

Easy to Share

Enhances the experience of sharing files by scanning a code. It automatically determines the network of the device to readily share the QR code across the extranet and the intranet. QR code encryption and extraction are also featured, providing privacy and data security through the required entry of a 6-digit password for verification.

File Management

Supports managing and using Office files, image, video and audio files, and file formats such as PDF and TXT.

Similar to Real Writing Experience

The electronic whiteboard supports pen-point writing. It comes equipped with specialized pressure-sensitive writing pens, designed to enhance the writing experience. With its soft, comfortable nib, writing on the whiteboard feels natural, similar to the real writing experience.

- Built-in DeepHub Meeting Software for cloud base online conference and with Realtime collaboration function.
- Displays in 4K Ultra HD and uses 4K UI.
- With its 2 built-in mid-high frequency speakers, and 1 low-frequency speaker, the device supports 2.1-channel audio output. The total power is 60 W.
- Produces vibrant visuals through its high color coverage (90% NTSC High Gamut Screen) and accurate color reproduction ($\Delta E \leq 1.5$).
- Features split screen, and performs screen sharing between the whiteboard and phones, computers, tablets and more devices.
- Microsoft Office and other related software can be installed, and it can play audio and video files in various formats.
- Offers a smooth writing experience through handwriting recognition, pen writing, the fast writing response speed, and pen pressure recognition for a real writing experience.
- Support AI recognition of text and drawings.
- Intelligent pen detection that automatically wakes up the whiteboard for annotations when the pen is lifted.
- Built-in AI 48M camera and 8 array microphone that produces excellent quality visual and audio communication. Supports auto-framing and voice tracking.
- Features sound source positioning.
- NFC and Fingerprint unlock for protection of user information.
- Includes a full-featured Type-C IN port and supports charging through USB PD up to 65 W.

Wireless Screen Sharing

In addition to basic file sharing, the device offers wireless screen sharing, interactive operations between two screens, and reverse transmissions. It also supports screen grouping (multiple transmission), host mode (for overall permission control), real-time transmission of images, videos and audios from the wireless camera of the mobile phone to the device, and split-screen mode that displays up to 9 splits on the same screen.

Screen Sharing

The content on your screen can be freely shared with one other device through a wired connection.

4K Camera with Ultra-wide FOV

8-MP with a maximum resolution of 4K@30 fps. It supports live videos and has an ultra-wide field of view (diagonal 99°, horizontal 87°, and vertical 49°), displaying vivid images even when placed in relatively large meeting rooms.

Technical Specification

Built-in System	
Operating System	Android 11.0
CPU	Quad-core A73 + Quad-core A53
CPU Frequency	2.2 GHz + 2.0 GHz
GPU	ARM Mali-G52 MP8 (8EE)
RAM	12 GB (System: 8 GB, Camera: 4 GB)
ROM	128 GB
Card Swiping with NFC	Yes, Bind up to 10 cards

Function	
Operating System of External Module	Windows 7/8/10
Wi-Fi Hotspot	Dual-band 2.4 G/5 G; supports enabling Hotspot and Wi-Fi at the same time

LCD Panel	
Panel Dimensions	75 inch
Backlight	DLED
Aspect Ratio	16:9
Brightness	400 cd/m ² (typ.)
Resolution	3840 (H) × 2160 (V)
Viewing Angle	H: 178°; V: 178°
Lifespan	≥50, 000 h
Display Color	90% NTSC (typ.)
Refresh Rate	60 Hz
Static Contrast	VA: 4000 (typ.); IPS: 1200 (typ.)
Response Time	8 ms (typ.)

Camera	
Pixel	48 MP
Auto Control	Auto flip; Auto white balance
Distortion	−8.6%
Max. Resolution	3840 (H) × 2160 (V)
Storage	8GB eMMC
Field of View	D: 99°; H: 87°; V: 49
Face Detection	Yes

Device Ports	
Light Sensor	1
Front Button	1 × power button (right side)
Front Ports	1 × USB 3.0 (left side)
Network Port	1 × RJ-45
Wi-Fi	Yes, 1 × Station, 1 × AP
Wi-Fi Standard	Station: 802.11b/g/n/a/ac AP: 802.11b/g/n/a/ac/ax

Wi-Fi Frequency Range	2400-2483.5 MHz, 5150-5350 MHz, 5470-5725 MHz, 5725-5850 MHz
MAX Power Transmission (Wi-Fi)	≤20 dBm@2400-2483.5 MHz; ≤23 dBm@5150-5250 MHz; ≤20 dBm@5250-5350 MHz; ≤27 dBm@5470-5725 MHz; ≤14 dBm@5725-5850 MHz
Bluetooth	Yes
Bluetooth Standard	BR/EDR/BLE, BT5.2
Bluetooth Frequency Range	2400-2483.5 MHz
MAX Power Transmission (Bluetooth)	≤20 dBm@2400-2483.5 MHz
RFID Modulation Method	ASK
RFID Frequency Range	13.56 MHz
MAX Power Transmission (RFID)	42 dBuA/m @10m
USB	3 × USB 3.0 (type A)+1 × Micro USB2.0
RS-232	1 × DB9 interface, male connector
Video Input	2 × HDMI 2.0 (4K@60Hz)
Video Output	1 × HDMI 2.0 (4K@60Hz)
Audio Output	1 × 3.5 mm Line Out interface; 1 × SPDIF interface
Others	1 × Touch interface
IrDA	1
Microphone	8 Array
Type-C Port	1 × Type-C IN (DP IN (4K60fps) +USB3.0 HOST+USB 2.0 Device (touch) +PD 65 W)

Touchscreen	
Response Time	≤10 ms
Touch Technology	Infrared touch technology
Touch Points	31@Android, 50@windows
Valid Touch	1.5 mm (0.06") (over 90% touch area)
Writing Mode	Finger + Pen (attaches magnetically)
Anti-light Interference	Anti-dazzle tempered glass
Surface Hardness	≥9 H
Touch Resolution	32767 × 32767
Number of Multi-user Writing Points	10 (over 90% touch area)

Speaker	
Number of Cavities	3
Frequency	150 Hz–20 kHz
Power	2.1 Channel, front full-range 2 × 20 W + rear subwoofer 20 W
Built-in Speaker	3
Fingerprint	
Fingerprint Capacity	100
Fingerprint Resolution	160 × 160

FAR	<0.001%
Microphone	
Pick-up Distance	Far-field sound pickup: 8 m—12 m (26.25 ft—39.37 ft)
Number of Microphones	8 Array
AGC	Yes
Echo Cancellation	Yes
Polar Pattern	Omnidirectional
Intelligent Noise Filtering	YES

General	
Power Supply	100—240 VAC, 50/60 Hz
Power Consumption	Basic power consumption: 272 W, Max. Power consumption: 350 W
Operating Temperature	0 °C to +40 °C (+32 °F to +104 °F)
Storage Temperature	−20 °C to +60 °C (−4 °F to +140 °F)
Operating Humidity	10%—90% (RH), non-condensing
Storage Humidity	10%—90% (RH), non-condensing
Product Material	Metal casing
Protective Glass	3.2 mm Anti-dazzle tempered glass
Casing Color (Frame/Rear)	Black on the left and right, silver on the top and bottom.
Product Dimensions	1702.2 mm × 93.3 mm × 1093.6 mm (67.14" × 3.67" × 43.06") (L × W × H)
Frame Size	Top border: 26.1 mm, left and right borders: 15.4 mm, bottom border: 66.6 mm
Packaging Dimensions	1813 mm × 262 mm × 1147 mm (71.38" × 10.31" × 45.16") (L × W × H)
Net Weight	59 kg (130.07 lb)
Gross Weight	69.5 kg (153.22 lb)
Holes Distance	600 mm × 400 mm (23.62" × 15.75")
Installation	Wall mount; mobile bracket
Standby Power Consumption	≤0.5 W
Packing List	1 × Smart interactive whiteboard; 1 × Power cord; 2 × Stylus pen; 1 × Quick start guide; 1 × Wall mount bracket; 1 × Accessory package; 1 × Remote control

Dimensions (mm[inch])

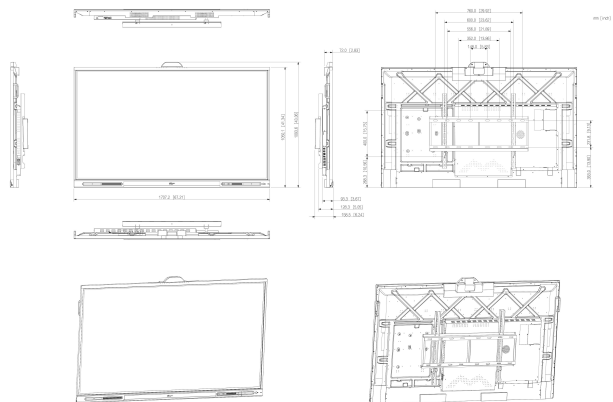

Panels

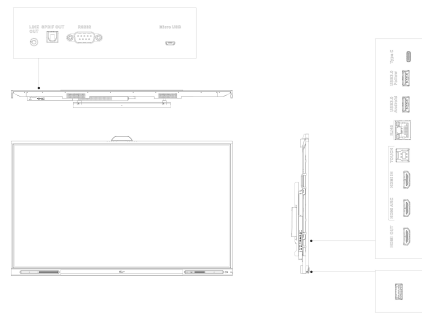

Ordering Information

Type	Model	Description
Smart interactive whiteboard	DHI-LPH75-MC470-P	75 inch Smart Interactive Whiteboard

DHI-LPH86-MC470-P

86 inch Smart Interactive Whiteboard



Series Overview

Dahua DeepHub Pro Smart Interactive Whiteboard is a new generation of smart interactive whiteboards that have a high performance main controller and multiple intelligent functions. It adopts direct-type LED backlight technology and has a 4K LED display that is built of anti-dazzle tempered glass with a hardness of 7 on the Mohs scale. The display comes in 65", 75", 86" and 98". This ultra-thin whiteboard supports up to 20 multi-user writing points and is equipped with a 48 MP motorized lens, speakers, 8 microphone arrays, and is touchscreen. It offers various functions such as video conferencing, writing on the whiteboard, wireless screen sharing and allows you to scan codes to access content on the whiteboard.

Functions

4K HD Display

With up to 3840 × 2160 resolution, the 4K HD display delivers a clear image in sharp, vivid colors.

AI Recognition of Drawings

Identifies hand-drawn structures such as straight lines, arrow-straight lines, arrow-dotted lines, triangles, parallelograms, trapezoids, rectangles, pentagons, circles, cylinders, pentagrams, semicircles, and ellipse.

Easy to Share

Enhances the experience of sharing files by scanning a code. It automatically determines the network of the device to readily share the QR code across the extranet and the intranet. QR code encryption and extraction are also featured, providing privacy and data security through the required entry of a 6-digit password for verification.

File Management

Supports managing and using Office files, image, video and audio files, and file formats such as PDF and TXT.

Screen Down Reachability

The system supports pulling down the screen to 1/3 the full height, to place the entire screen at a reachable distance for you.

Similar to Real Writing Experience

The electronic whiteboard supports pen-point writing. It comes equipped with specialized pressure-sensitive writing pens, designed to enhance the writing experience. With its soft, comfortable nib, writing on the whiteboard feels natural, similar to the real writing experience.

- Built-in DeepHub Meeting Software for cloud base online conference and with Realtime collaboration function.
- Displays in 4K Ultra HD and uses 4K UI.
- With its 2 built-in mid-high frequency speakers, and 1 low-frequency speaker, the device supports 2.1-channel audio output. The total power is 60 W.
- Produces vibrant visuals through its high color coverage (90% NTSC High Gamut Screen) and accurate color reproduction ($\Delta E \leq 1.5$).
- Features split screen, and performs screen sharing between the whiteboard and phones, computers, tablets and more devices.
- Microsoft Office and other related software can be installed, and it can play audio and video files in various formats.
- Offers a smooth writing experience through handwriting recognition, pen writing, the fast writing response speed, and pen pressure recognition for a real writing experience.
- Support AI recognition of text and drawings.
- Intelligent pen detection that automatically wakes up the whiteboard for annotations when the pen is lifted.
- Built-in AI 48M camera and 8 array microphone that produces excellent quality visual and audio communication. Supports auto-framing and voice tracking.
- Features sound source positioning.
- NFC and Fingerprint unlock for protection of user information.
- Includes a full-featured Type-C IN port and supports charging through USB PD up to 65 W.

Text Recognition

Converts written letters into text in real time, using the default font of the system.

Wireless Screen Sharing

In addition to basic file sharing, the device offers wireless screen sharing, interactive operations between two screens, and reverse transmissions. It also supports screen grouping (multiple transmission), host mode (for overall permission control), real-time transmission of images, videos and audios from the wireless camera of the mobile phone to the device, and split-screen mode that displays up to 9 splits on the same screen.

Screen Sharing

The content on your screen can be freely shared with one other device through a wired connection.

4K Camera with Ultra-wide FOV

8-MP with a maximum resolution of 4K@30 fps. It supports live videos and has an ultra-wide field of view (diagonal 99°, horizontal 87°, and vertical 49°), displaying vivid images even when placed in relatively large meeting rooms.

Technical Specification

Built-in System	
Operating System	Android 11.0
CPU	Quad-core A73 + Quad-core A53
CPU Frequency	2.2 GHz + 2.0 GHz
GPU	ARM Mali-G52 MP8 (8EE)
RAM	12 GB (System: 8 GB, Camera: 4 GB)
ROM	128 GB
Card Swiping with NFC	Yes, Bind up to 10 cards

Function	
Operating System of External Module	Windows 7/8/10
Wi-Fi Hotspot	Dual-band 2.4 G/5 G; supports enabling Hotspot and Wi-Fi at the same time

LCD Panel	
Panel Dimensions	86 inch
Backlight	DLED
Aspect Ratio	16:9
Brightness	400 cd/m ² (typ.)
Resolution	3840 (H) × 2160 (V)
Viewing Angle	H: 178°; V: 178°
Lifespan	≥50, 000 h
Display Color	90% NTSC (typ.)
Refresh Rate	60 Hz
Static Contrast	VA: 4000 (typ.); IPS: 1200 (typ.)
Response Time	8 ms (typ.)

Camera	
Pixel	48 MP
Auto Control	Auto flip; Auto white balance
Distortion	−8.6%
Max. Resolution	3840 (H) × 2160 (V)
Storage	8GB eMMC
Field of View	D: 99°; H: 87°; V: 49
Face Detection	Yes

Device Ports	
Light Sensor	1
Front Button	1 × power button (right side)
Front Ports	1 × USB 3.0 (left side)
Network Port	1 × RJ-45
Wi-Fi	Yes, 1 × Station, 1 × AP
Wi-Fi Standard	Station: 802.11b/g/n/a/ac AP: 802.11b/g/n/a/ac/ax

Wi-Fi Frequency Range	2400-2483.5 MHz, 5150-5350 MHz, 5470-5725 MHz, 5725-5850 MHz
MAX Power Transmission (Wi-Fi)	≤20 dBm@2400-2483.5 MHz; ≤23 dBm@5150-5250 MHz; ≤20 dBm@5250-5350 MHz; ≤27 dBm@5470-5725 MHz; ≤14 dBm@5725-5850 MHz
Bluetooth	Yes
Bluetooth Standard	BR/EDR/BLE, BT5.2
Bluetooth Frequency Range	2400-2483.5MHz
MAX Power Transmission (Bluetooth)	≤20 dBm@2400-2483.5 MHz
RFID Modulation Method	ASK
RFID Frequency Range	13.56 MHz
MAX Power Transmission (RFID)	42 dBuA/m @10m
USB	3 × USB 3.0 (type A); 1 × Micro USB2.0
RS-232	1 × DB9 interface, male connector
Video Input	2 × HDMI 2.0 (4K@60Hz)
Video Output	1 × HDMI 2.0 (4K@60Hz)
Audio Output	1 × 3.5 mm Line Out interface; 1 × SPDIF interface
Others	1 × Touch interface
IrDA	1
Microphone	8 Array
Type-C Port	1× Type-C IN (DP IN (4K60fps) +USB3.0 HOST+USB 2.0 Device (touch) +PD 65 W)

Touchscreen	
Response Time	≤10 ms
Touch Technology	Infrared touch technology
Touch Points	31@Android, 50@windows
Valid Touch	1.5 mm (0.06") (over 90% touch area)
Writing Mode	Finger + Pen (attaches magnetically)
Anti-light Interference	Anti-dazzle tempered glass
Surface Hardness	≥9 H
Touch Resolution	32767 × 32767
Number of Multi-user Writing Points	10 (over 90% touch area)

Speaker	
Number of Cavities	3
Frequency	150 Hz–20 kHz
Power	2.1 Channel, front full-range 2 × 20 W + rear subwoofer 20 W
Built-in Speaker	3
Fingerprint	
Fingerprint Capacity	100
Fingerprint Resolution	160 × 160

FAR	<0.001%
Microphone	
Pick-up Distance	Far-field sound pickup: 8 m—12 m (26.25 ft—39.37 ft)
Number of Microphones	8 Array
AGC	Yes
Echo Cancellation	Yes
Polar Pattern	Omnidirectional
Intelligent Noise Filtering	YES

General

Power Supply	100—240 VAC, 50/60 Hz
Power Consumption	Basic power consumption: 425 W, Max. Power consumption: 500 W
Operating Temperature	0 °C to +40 °C (+32 °F to +104 °F)
Storage Temperature	−20 °C to +60 °C (−4 °F to +140 °F)
Operating Humidity	10%—90% (RH), non-condensing
Storage Humidity	10%—90% (RH), non-condensing
Product Material	Metal casing
Protective Glass	3.2 mm Anti-dazzle tempered glass
Casing Color (Frame/Rear)	Black on the left and right, silver on the top and bottom.
Product Dimensions	1953.4 mm × 93.3 mm × 1093.6 mm (76.91" × 3.67" × 43.52") (L × W × H)
Frame Size	Top border: 26.1 mm, left and right borders: 15.4 mm, bottom border: 66.6 mm
Packaging Dimensions	2058 mm × 262 mm × 1322 mm (81.02" × 10.31" × 52.05") (L × W × H)
Net Weight	73 kg (160.94 lb)
Gross Weight	86.5 kg (190.70 lb)
Holes Distance	750 mm × 400 mm (29.53" × 15.75")
Installation	Wall mount; mobile bracket
Standby Power Consumption	≤0.5 W
Packing List	1 × Smart interactive whiteboard; 1 × Power cord ; 2 × Stylus pen; 1 × Quick start guide; 1 × Wall mount bracket; 1 × Accessory package; 1 × Remote control

Dimensions (mm[inch])

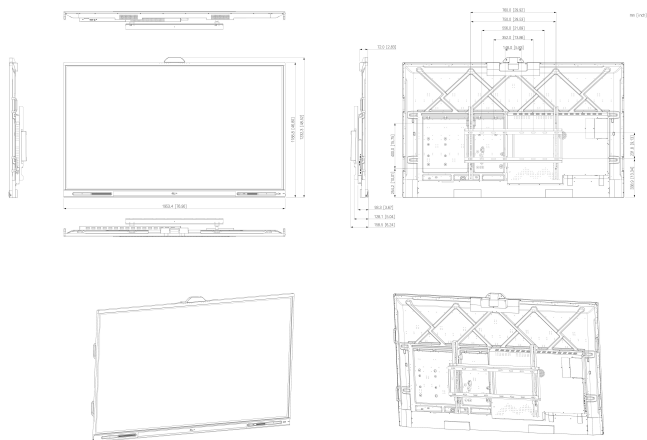

Panels

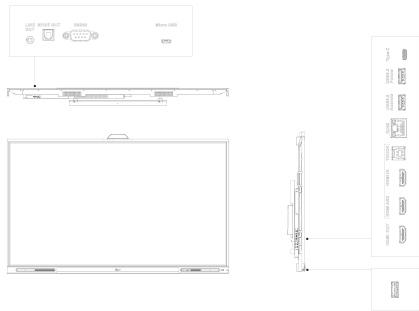

Ordering Information

Type	Model	Description
Smart interactive whiteboard	DHI-LPH86-MC470-P	86 inch Smart Interactive Whiteboard

DHI-LPH98-MC470-P

98 inch Smart Interactive Whiteboard



Series Overview

Dahua DeepHub Pro Smart Interactive Whiteboard is a new generation of smart interactive whiteboards that have a high performance main controller and multiple intelligent functions. It adopts direct-type LED backlight technology and has a 4K LED display that is built of anti-dazzle tempered glass with a hardness of 7 on the Mohs scale. The display comes in 65", 75", 86" and 98". This ultra-thin whiteboard supports up to 20 multi-user writing points and is equipped with a 48 MP motorized lens, speakers, 8 microphone arrays, and is touchscreen. It offers various functions such as video conferencing, writing on the whiteboard, wireless screen sharing and allows you to scan codes to access content on the whiteboard.

Functions

4K HD Display

With up to 3840 × 2160 resolution, the 4K HD display delivers a clear image in sharp, vivid colors.

AI Recognition of Drawings

Identifies hand-drawn structures such as straight lines, arrow-straight lines, arrow-dotted lines, triangles, parallelograms, trapezoids, rectangles, pentagons, circles, cylinders, pentagrams, semicircles, and ellipse.

Easy to Share

Enhances the experience of sharing files by scanning a code. It automatically determines the network of the device to readily share the QR code across the extranet and the intranet. QR code encryption and extraction are also featured, providing privacy and data security through the required entry of a 6-digit password for verification.

File Management

Supports managing and using Office files, image, video and audio files, and file formats such as PDF and TXT.

Similar to Real Writing Experience

The electronic whiteboard supports pen-point writing. It comes equipped with specialized pressure-sensitive writing pens, designed to enhance the writing experience. With its soft, comfortable nib, writing on the whiteboard feels natural, similar to the real writing experience.

- Built-in DeepHub Meeting Software for cloud base online conference and with Realtime collaboration function.
- Displays in 4K Ultra HD and uses 4K UI.
- With its 2 built-in mid-high frequency speakers, and 1 low-frequency speaker, the device supports 2.1-channel audio output. The total power is 60 W.
- Produces vibrant visuals through its high color coverage (90% NTSC High Gamut Screen) and accurate color reproduction ($\Delta E \leq 1.5$).
- Features split screen, and performs screen sharing between the whiteboard and phones, computers, tablets and more devices.
- Microsoft Office and other related software can be installed, and it can play audio and video files in various formats.
- Offers a smooth writing experience through handwriting recognition, pen writing, the fast writing response speed, and pen pressure recognition for a real writing experience.
- Support AI recognition of text and drawings.
- Intelligent pen detection that automatically wakes up the whiteboard for annotations when the pen is lifted.
- Built-in AI 48M camera and 8 array microphone that produces excellent quality visual and audio communication. Supports auto-framing and voice tracking.
- Features sound source positioning.
- NFC and Fingerprint unlock for protection of user information.
- Includes a full-featured Type-C IN port and supports charging through USB PD up to 65 W.

Wireless Screen Sharing

In addition to basic file sharing, the device offers wireless screen sharing, interactive operations between two screens, and reverse transmissions. It also supports screen grouping (multiple transmission), host mode (for overall permission control), real-time transmission of images, videos and audios from the wireless camera of the mobile phone to the device, and split-screen mode that displays up to 9 splits on the same screen.

Screen Sharing

The content on your screen can be freely shared with one other device through a wired connection.

4K Camera with Ultra-wide FOV

8-MP with a maximum resolution of 4K@30 fps. It supports live videos and has an ultra-wide field of view (diagonal 99°, horizontal 87°, and vertical 49°), displaying vivid images even when placed in relatively large meeting rooms.

Technical Specification

Built-in System	
Operating System	Android 11.0
CPU	Quad-core A73 + Quad-core A53
CPU Frequency	2.2 GHz + 2.0 GHz
GPU	ARM Mali-G52 MP8 (8EE)
RAM	12 GB (System: 8 GB, Camera: 4 GB)
ROM	128 GB
Card Swiping with NFC	Yes, Bind up to 10 cards

Function	
Operating System of External Module	Windows 7/8/10
Wi-Fi Hotspot	Dual-band 2.4 G/5 G; supports enabling Hotspot and Wi-Fi at the same time

LCD Panel	
Panel Dimensions	98 inch
Backlight	DLED
Aspect Ratio	16:9
Brightness	400 cd/m ² (typ.)
Resolution	3840 (H) × 2160 (V)
Viewing Angle	H: 178°; V: 178°
Lifespan	≥50, 000 h
Display Color	90% NTSC (typ.)
Refresh Rate	60 Hz
Static Contrast	VA: 4000 (typ.); IPS: 1200 (typ.)
Response Time	8 ms (typ.)

Camera	
Pixel	48 MP
Auto Control	Auto flip; Auto white balance
Distortion	−8.6%
Max. Resolution	3840 (H) × 2160 (V)
Storage	8 GB eMMC
Field of View	D: 99°; H: 87°; V: 49
Face Detection	Yes

Device Ports	
Light Sensor	1
Front Button	1 × power button (right side)
Front Ports	1 × USB 3.0 (left side)
Network Port	1 × RJ-45
Wi-Fi	Yes, 1 × Station, 1 × AP
Wi-Fi Standard	Station: 802.11b/g/n/a/ac AP: 802.11b/g/n/a/ac/ax

Wi-Fi Frequency Range	2400-2483.5 MHz, 5150-5350 MHz, 5470-5725 MHz, 5725-5850 MHz
MAX Power Transmission (Wi-Fi)	≤20 dBm@2400-2483.5 MHz; ≤23 dBm@5150-5250 MHz; ≤20 dBm@5250-5350 MHz; ≤27 dBm@5470-5725 MHz; ≤14 dBm@5725-5850 MHz
Bluetooth	Yes
Bluetooth Standard	BR/EDR/BLE, BT5.2
Bluetooth Frequency Range	2400-2483.5 MHz
MAX Power Transmission (Bluetooth)	≤20 dBm@2400-2483.5 MHz
RFID Modulation Method	ASK
RFID Frequency Range	13.56 MHz
MAX Power Transmission (RFID)	42 dBuA/m @10m
USB	3 × USB 3.0 (type A); 1 × Micro USB2.0
RS-232	1 × DB9 interface, male connector
Video Input	2 × HDMI 2.0 (4K@60 Hz)
Video Output	1 × HDMI 2.0 (4K@60 Hz)
Audio Output	1 × 3.5 mm Line Out interface; 1 × SPDIF interface
Others	1 × Touch interface
IrDA	1
Microphone	8 Array
Type-C Port	1× Type-C IN (DP IN (4K60fps) +USB3.0 HOST+USB 2.0 Device (touch) +PD 65 W)

Touchscreen	
Response Time	≤10 ms
Touch Technology	Infrared touch technology
Touch Points	31@Android, 50@windows
Valid Touch	1.5 mm (0.06") (over 90% touch area)
Writing Mode	Finger + Pen (attaches magnetically)
Anti-light Interference	Anti-dazzle tempered glass
Surface Hardness	≥9 H
Touch Resolution	32767 × 32767
Number of Multi-user Writing Points	10 (over 90% touch area)

Speaker	
Number of Cavities	3
Frequency	150 Hz–20 kHz
Power	2.1 Channel, front full-range 2 × 20 W + rear subwoofer 20 W
Built-in Speaker	3
Fingerprint	
Fingerprint Capacity	100
Fingerprint Resolution	160 × 160

FAR	<0.001%
Microphone	
Pick-up Distance	Far-field sound pickup: 8 m—12 m (26.25 ft—39.37 ft)
Number of Microphones	8 Array
AGC	Support
Echo Cancellation	Support
Polar Pattern	Omnidirectional
Intelligent Noise Filtering	YES

General

Power Supply	100—240 VAC, 50/60 Hz
Power Consumption	Basic power consumption: 555 W, Max. Power consumption: 650 W
Operating Temperature	0 °C to +40 °C (+32 °F to +104 °F)
Storage Temperature	−20 °C to +60 °C (−4 °F to +140 °F)
Operating Humidity	10%—90% (RH), non-condensing
Storage Humidity	10%—90% (RH), non-condensing
Product Material	Metal casing
Protective Glass	3.2 mm Anti-dazzle tempered glass
Casing Color (Frame/Rear)	Black on the left and right, silver on the top and bottom.
Product Dimensions	2216.8 mm × 110.2 mm × 1383.3 mm (87.26" × 4.37" × 54.46") (L × W × H)
Frame Size	Top border: 26.1 mm, left and right borders: 15.4 mm, bottom border: 66.6 mm
Packaging Dimensions	2342 mm × 260 mm × 1485 mm (92.20" × 10.24" × 58.46") (L × W × H)
Net Weight	102 kg (224.87 lb)
Gross Weight	118.5 kg (261.25 lb)
Holes Distance	1000 mm × 400 mm (39.37" × 15.75")
Installation	Wall mount; mobile bracket
Standby Power Consumption	≤0.5 W
Packing List	1 × Smart interactive whiteboard; 1 × Power cord ; 2 × Stylus pen; 1 × Quick start guide; 1 × Wall mount bracket; 1 × Accessory package; 1 × Remote control

Dimensions (mm[inch])

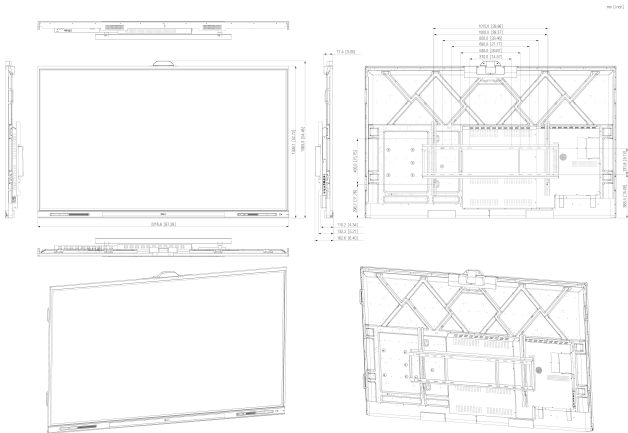

Panels

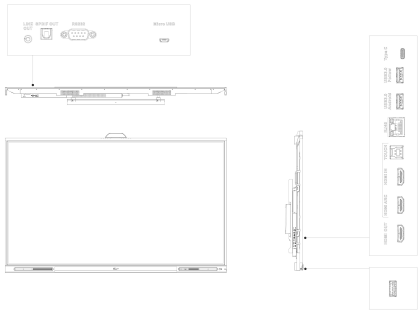

Ordering Information

Type	Model	Description
Smart interactive whiteboard	DHI-LPH98-MC470-P	98 inch Smart Interactive Whiteboard